

AUTOMATIC TRANSAXLE SHIFT MECHANISM LOCATION INDEX

B3E051846010W01

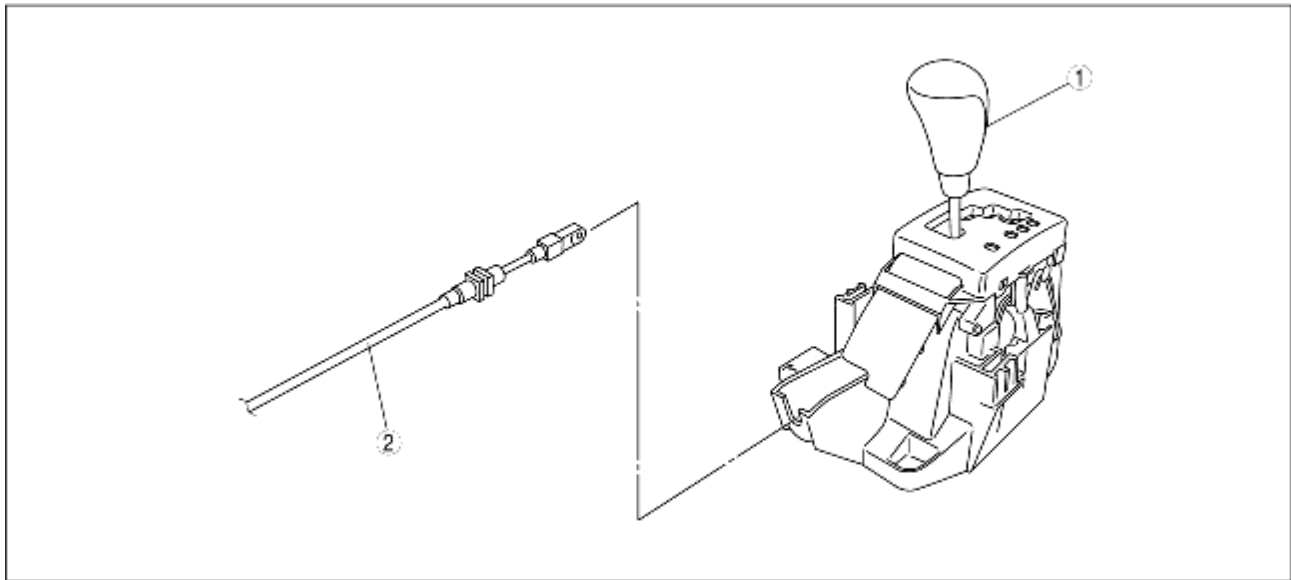

B3E0518W001

| | |
|---|--|
| 1 | Selector lever (See SELECTOR LEVER INSPECTION.) (See SELECTOR LEVER COMPONENT INSPECTION.) (See SELECTOR LEVER COMPONENT REMOVAL/INSTALLATION.) (See SELECTOR LEVER DISASSEMBLY/ASSEMBLY.) |
| 2 | Selector cable (See SELECTOR CABLE ADJUSTMENT.) |